



3 Bin Aggregate Weigh Batching Plant



Model 30 Gear Box Mixer



SPM 20 Concrete Products Machine



Inclined Mud Belt Conveyor



Hydraulic Offbearer

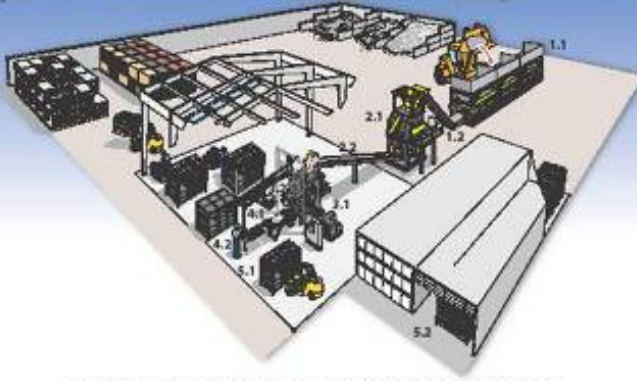

Model SPM 20 Concrete Products Plant with Model 30 Mixer

Item	Description	Power (h.p.)
1.1	• 3 or 4 Bin Aggregate Weigh Batching Plant Rack, 4 bins, for on storage of aggregate and scale discharge via gathering belt conveyor for weighing	7
1.2	• Inclined Aggregate Belt Conveyor Designed for belt aggregate and sand from weigh batching plant to mixer	5
2.1	• Model 30 Gearbox Mixer (Ribbon Type) Designed to mix up to 1000 kg of aggregate and cement	40
2.2	• Inclined Mud Belt Conveyor Designed to feed concrete into form after to concrete products machine	5/7.5
3.1	• Model SPM 20 Concrete Products Machine Designed to produce concrete products on small pallets of size 2'0" x 2'0" (508mm x 508mm). Max. product height is 9" (230mm)	30
3.2	• Front Feed Drawer Assembly Designed to facilitate top layer for concrete products on Model SPM 20	-
4.1	• Green Product Rollaway Designed to receive pallets of green product from mixer/mixer/hold for loading into curing racks	1
4.2	• Hydraulic Offbearer with Support Structure Designed to pick up concrete pallets & products to allow them for loading into curing racks	-
5.1	• Steel Production Pallets - 20" x 20" x 25" (508mm x 508mm x 635mm) Designed to hold concrete products during production, curing and handling	-
5.2	• Steel Curing Racks For storage of concrete products on pallets during curing process	-



HOLLOW BLOCK
390x190x190 mm
(2) at a time

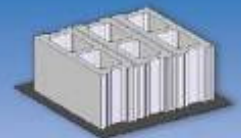

HOLLOW BLOCK
390x140x190 mm
(3) at a time

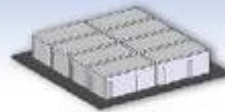

BRICK PAVER
200x100x80 mm
(8) at a time



UNISTONE PAVER
225x112.5x80 mm
(8) at a time



FLYASH BRICK
230x110x70 mm
(8) at a time



FLYASH BRICK
230x110x70 mm
(12) at a time

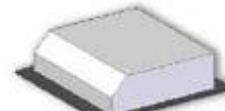

KERBSTONE
400x450x125 mm
(1) at a time



RETAINING WALL BLOCK
460x340x200 mm
(1) at a time

